

LUX[®] *Legacy*[™]

BY

A E R U S

Upright Vacuum Cleaner
for floors and carpets

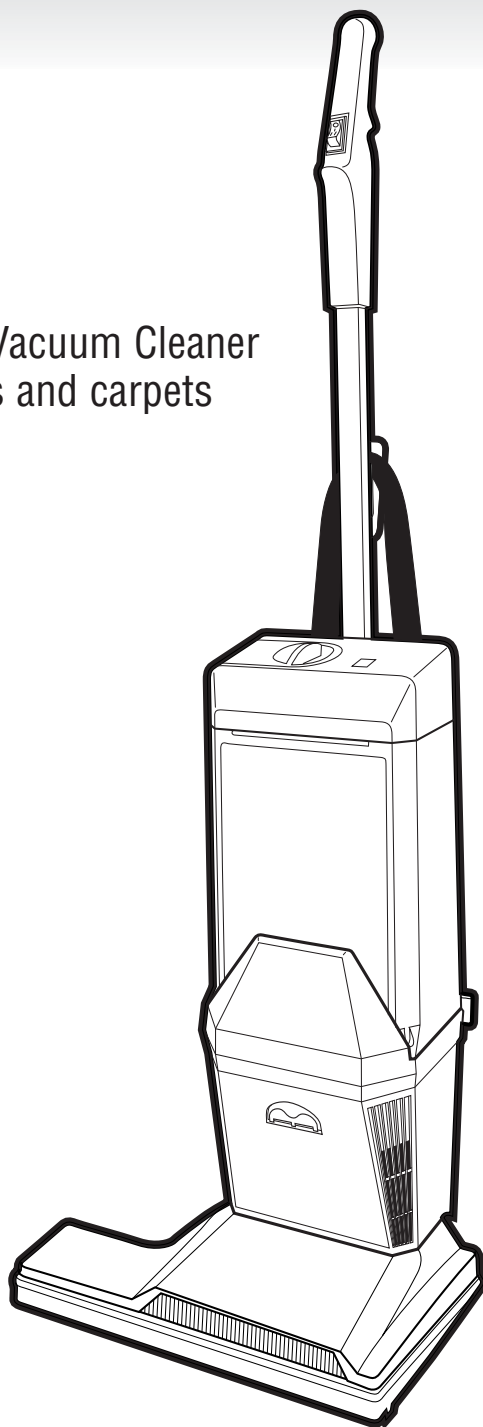

FOR HOUSEHOLD USE
BEFORE OPERATING YOUR VACUUM, PLEASE READ THESE INSTRUCTIONS CAREFULLY.

Important Safety Instructions

When using an electrical appliance, basic precautions should always be taken.

READ ALL INSTRUCTIONS BEFORE USING THIS VACUUM CLEANER

WARNING

To reduce the risk of fire, electrical shock or injury:

- **Use only as described in this manual.**
- **Use only manufacturer's recommended attachments.**
- **Turn off appliance before connecting or disconnecting hose or power attachments.**
- **Do not use if hose is damaged, cut, or punctured.** Avoid vacuuming sharp objects.
- **Do not use without filter bag and/or exhaust afterfilter in place.**
- **Do not put any object into openings. Do not use with any opening blocked.** Keep free of dust, lint, hair, or other materials that may reduce airflow.
- **Do not handle plug or appliance with wet hands.**
- **Do not allow to be used as a toy.**
- **Do not allow appliance to be operated by or near children.**
- **Use extra care when cleaning on stairs.**
- **Do not use outdoors or on wet surfaces.**
- **Do not use to vacuum flammable or combustible liquids such as gasoline.** Do not use in areas where such liquids may be present.
- **Do not vacuum anything that is burning or smoking, such as cigarettes, matches, or hot ashes.**
- **Keep hair, loose clothing, fingers, and all parts of body away from openings and moving parts.**
- **Do not leave appliance unattended when plugged in. Unplug from outlet when not in use and before servicing.**
- **Do not change the plug in any way. Do not use adapters.** To reduce risk of electrical shock, this appliance has a polarized plug. This plug will fit in an electrical outlet only one way. If it does not fit, contact a qualified electrician to install the proper outlet.
- **Turn off all controls before unplugging.**
- **Do not unplug by pulling on cord.** To unplug, grasp the plug, not the cord.
- **Hold plug when rewinding onto cord reel.** Do not allow plug to whip when rewinding.
- **Unplug before connecting non-electrical mechanical accessories.**
- **Do not use with damaged cord or plug.**
- **Do not pull or carry by cord, use cord as a handle, close door on cord, or pull cord around sharp edges or corners.** Do not run appliance over cord. Keep cord away from heated surfaces.
- **Do not attempt to service this unit.** Return appliance to an authorized Aerus center if it is not working properly, has been dropped, damaged, left outdoors, or dropped into water.

Save These Instructions

Welcome to the Aerus World of Excellence!

Your new Aerus Lux® Legacy has been designed and built to provide you with the best in cleaning power, convenience and durability.

With its powerful, two-motor cleaning system, light weight and maneuverability, this deluxe upright will provide you with years of easy and trouble-free vacuum cleaning. Used with a variety of optional attachments, your Aerus **Lux® Legacy** becomes a complete home cleaning system, able to handle everything from big cleaning chores to quick tidying.

The following pages are designed to answer questions concerning the use of your Aerus **Lux® Legacy**. For additional information regarding this or any of our fine products please contact your local Aerus representative; or call Aerus customer service toll-free at:

1-800-243-9078 (in the U.S.)

1-800-668-0763 (in Canada)

FEATURES

- ❶ Combination Cord Cleat/Cord Release
- ❷ Handle
- ❸ Bag Compartment Release Button
- ❹ Power Cord
- ❺ Handle Mounting Screw
- ❻ Carry Handle
- ❼ Lower Cord Wrap
- ❽ Reset Button
- ❾ Accessory Receptacle
- ❿ Bulkhead
- ⓫ Control Switch
- ⓬ Accessory Hose Port
- ⓭ Bag Change Indicator
- ⓮ Bag Compartment Lid
- ⓯ Exhaust Afterfilter Housing Door

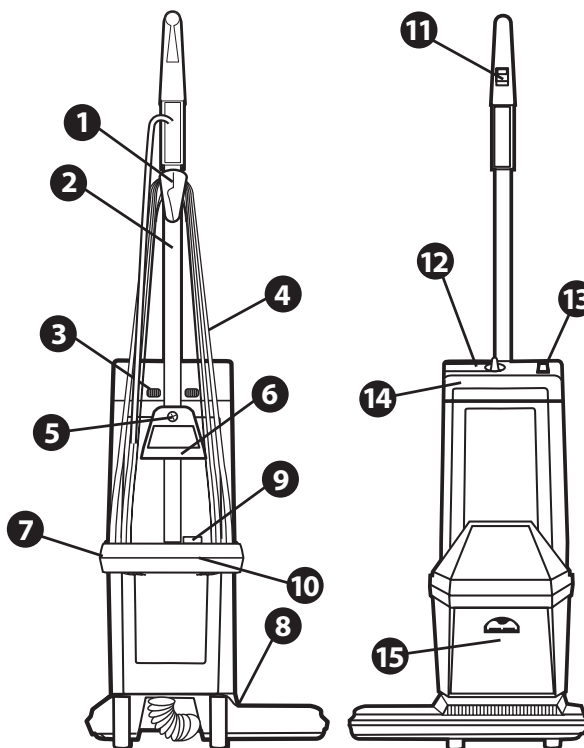

Fill In and Save

Locate the serial number of your new upright vacuum cleaner behind the handle, above the recessed electrical receptacle. Write it here and retain for future reference.

Serial No. _____

Model No. _____

Date of Purchase _____

HANDLE ASSEMBLY

The operating handle of your new **Lux® Legacy** can easily be attached to your cleaner as follows:

CAUTION: Be sure unit is **NOT** plugged in before assembling handle.

- Locate the handle assembly **1**. Remove the mounting screw **6** and nut plate **2** from the handle.
- Open the cleaner bag compartment lid, remove the filter bag. Place the nut plate into the pocket **3** inside the bag compartment as shown.
- Fit the end of the handle into the handle receptacle **4**.
IMPORTANT: Press down firmly when plugging handle into the receptacle.
- Hold the handle against the bag compartment, attach the carry handle **7** and thread the mounting screw **6** through the handles into the nut plate.
- Tighten the mounting screw securely using a screwdriver.

NOTE: The handle must be properly inserted into the receptacle for the screw to engage the nut plate(2).

- The accessory plug **5** is an electrical connection for powered accessories such as the Sidekick®.

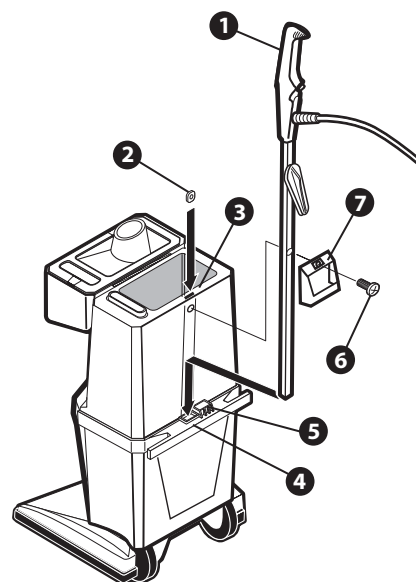

NOTE: This appliance has a polarized plug (one blade is wider than the other). This plug will fit in a polarized outlet only one way. If the plug does not fit fully in the outlet, reverse the plug. If it still does not fit, contact a qualified electrician to install the proper outlet. Do not change the plug in any way.

POWER CORD STORAGE

Your cleaner includes a Combination Cord Cleat/Cord Holder: To remove the cord rotate the cord cleat until the power cord is released **A**. Remove the cord from the lower cord wrap. Connect the cord plug into a 120V/60Hz power supply.

As an additional feature the cord cleat serves as a cord holder while the cleaner is in use. Rotate the cord cleat until it snaps into the "Release" position, the top portion of the cord cleat forms a cord holder. Snap the cord into the holder **B** and the cord will be held out of the way while you vacuum.

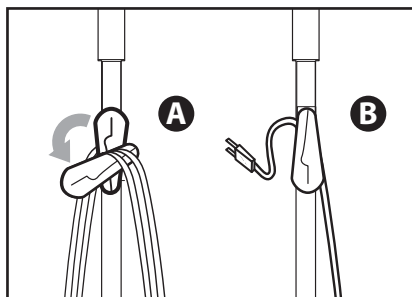

To store the cord: Rotate the cord cleat into the "Storage" position. Wrap the cord around the cord cleat and the lower cord wrap **C**. Snap the end of the cord plug over the cord for secure storage.

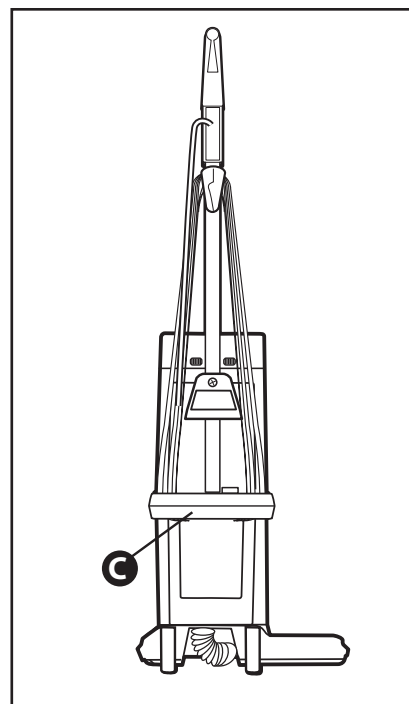

BASIC OPERATION

WARNING: Electric shock could occur if used outdoors or on wet surfaces. Do not operate your cleaner in the presence of explosive or flammable material or fumes.

Plug cord into a standard 120 V. A.C. outlet. Be sure unit switch is in the OFF position.

- D** The control switch has three positions: OFF (O), FLOOR (I), and CARPET (II).
- O** Always set the switch to OFF (O) when the cleaner is not in use.
 - I** Set the switch to FLOOR (I) to stop the rotating brush, using the powerful air flow alone to clean hard floors, delicate antique rugs and for above-the-floor cleaning.
 - II** Set the switch to CARPET (II) for deep cleaning rugs and carpets.
- E** The cleaner automatically locks in the upright position. To release the handle, place foot lightly on the base of the machine and gently pull operating handle backwards. Once the lock is disengaged, the handle will move up and down freely as you clean.
- F** If the brush does not rotate when switch is set to CARPET (II), press the RESET button (F) located on the base of the cleaner. Do not pull on cord to unplug unit. **Carefully grasp plug and pull from outlet.**
- G** The upright position should be used when carrying or storing the cleaner. Your cleaner will roll easily from room to room, over carpets and sills, when you lock the handle and tilt the machine onto its rear wheels.

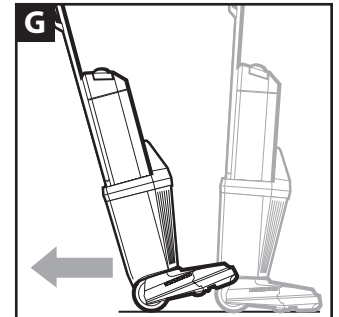
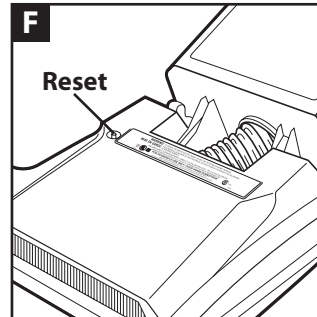
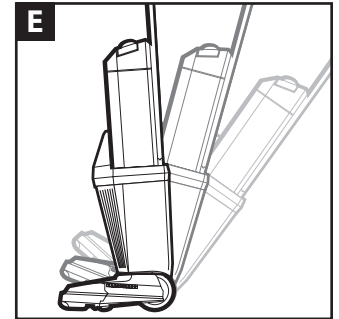
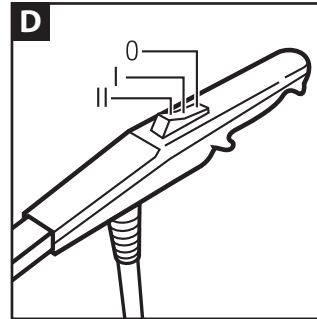

AUTOMATIC SHUT-OFF FOR CAUGHT OBJECTS

If an object becomes caught in the rotating agitator brush, the brush motor will automatically shut off. This automatic shut-off protects your cleaner from overheating and enables you to remove the caught object.

- Turn the cleaner **OFF**.
- Unplug the cleaner from the wall outlet.
- Place the cleaner on its side or back and gently remove the caught object from the agitator brush area **H**.
- Replug the electric cord, and press the RESET button on the base of the cleaner as shown **I**.
- Switch the cleaner on to continue vacuuming.

HINT: Inspect the rotating brush occasionally and remove any debris wrapped around the brush.

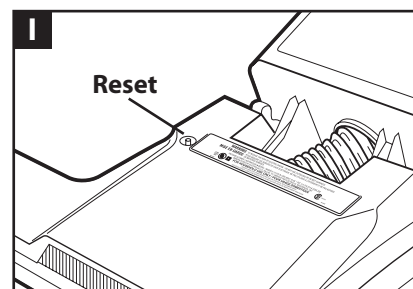
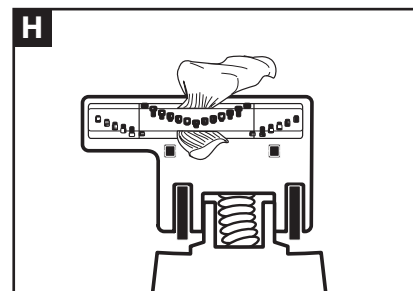

ABOVE-THE-FLOOR CLEANING

To use your above-the-floor attachments

- Turn control switch to "OFF" and be certain cleaner is locked in the upright position.
- Lift open the adapter access plug **J** located on top of the bag compartment lid. Insert hose as shown and firmly push into position, twisting slightly as you push. Hose is in proper position when it can go in no further. Insert accessory plug **K** into accessory receptacle located beside handle receptacle.

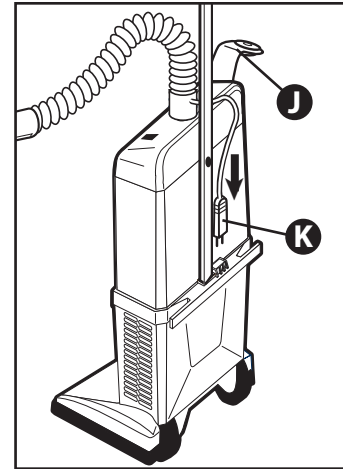

CAUTION: Your vacuum cleaner may be imbalanced while using above the floor attachments and prone to fall. Be sure and support your cleaner by either holding the handle with a free hand or leaning the handle assembly against a wall for extra support (L).

- Plug vacuum cleaner power cord into electrical receptacle.
- Turn control switch to "FLOOR" position to begin cleaning.

NOTE: The Full Bag Indicator does not work when the accessory hose is attached.

CAUTION: When using above-the-floor cleaning attachments, the vacuum cleaner control switch must be in the "FLOOR" position. Using the "CARPET" position while cleaning above-the-floor may cause unnecessary wear and tear to carpets.

TIPS FOR ABOVE-THE-FLOOR CLEANING

For best control and ease of maneuverability, always keep one hand on vacuum cleaner handle while using above-the-floor attachments. The cleaner will roll easily while the machine is locked in the upright position and tilted onto its rear wheels **L**.

After completing above-the-floor cleaning, remove hose and close the adapter access plug. When closing plug, be certain that all plug edges are firmly sealed **M**.

To reduce suction when cleaning curtains and light draperies, open suction control valve on hose handle **N**.

Combination dusting brush/upholstery tool **O**: May be attached directly to the hose handle or wand. Twist slightly to secure. Use the brush end to clean hard surfaces such as end tables. Reverse the tool to clean upholstery or fabrics. You may adjust the wings to the contour of your furniture.

For narrow, hard to reach areas, the crevice nozzle may be used on the wand or directly on the hose handle **P**.

Slip the handle end of the flexible hose into the flared end of the wand **Q**.

For longer reach, assemble the two lightweight wands as shown **R**.

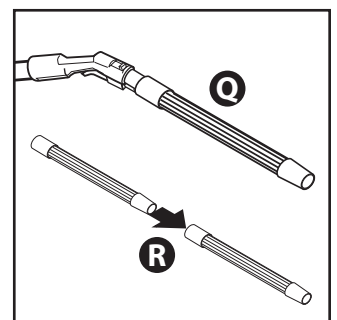
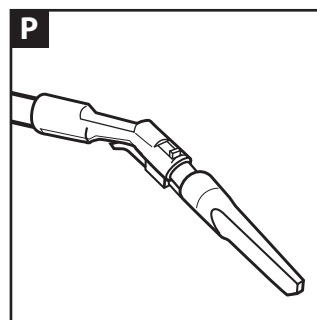
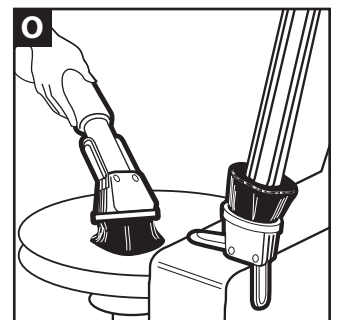
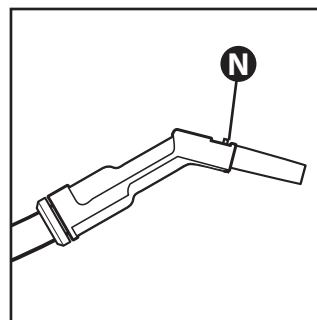
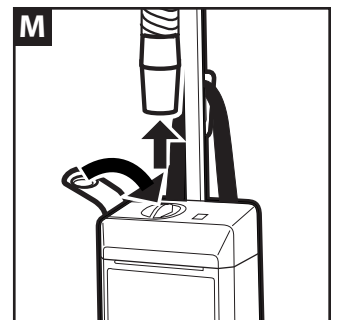
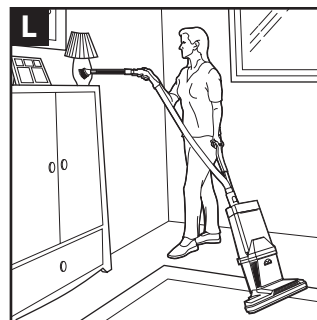

USING THE *SIDEKICK*®

To further your cleaning capabilities, Aerus gives you the newest advancement in the cleaning world. The *Sidekick*® accessory is a revolutionary new tool powered by its own motor that combines superior cleaning action with easy maneuverability. The *Sidekick*® has a trim design that allows cleaning hard-to-reach areas like stairs, car interiors, bathrooms, upholstery and mattresses, easier than ever before.

POWER ON/OFF

The *Sidekick*® has two positions:

- “**I**” turns the *Sidekick*® **ON**.
- “**O**” turns the *Sidekick*® **OFF**.



CAUTION: Always turn cleaner **OFF** before connecting or disconnecting *Sidekick*®.

SIDEKICK® ASSEMBLY

To attach the *Sidekick*®:

- Turn cleaner **OFF** and unplug cord from outlet.
- Disconnect wand or power nozzle attachment from hose.
- Turn the *Sidekick*® switch to the **OFF** position.
- Align the *Sidekick*® and hose connections and slip the *Sidekick*® onto handgrip **S** until it snaps into place.
- Plug power cord into outlet, turn machine **ON**, turn the *Sidekick*® **ON** and resume cleaning.

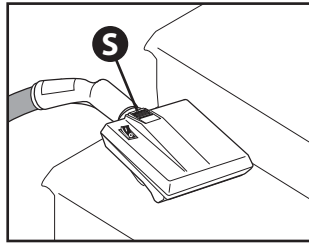

To remove the *Sidekick*®:

- Turn both the *Sidekick*® and the cleaner **OFF**, then unplug power cord.
- Press release and detach the *Sidekick*® from handgrip.

CAUGHT OBJECTS

If an object becomes caught in the *Sidekick*®, **immediately turn the *Sidekick*® OFF.**

To restart, follow these instructions:

- Turn cleaner **OFF** and unplug power cord from wall outlet.
- Remove caught object from the *Sidekick*®.
 - If the object is caught in the revolving brush turn the *Sidekick*® over and gently remove the caught object from the brush.
 - If object is caught further in the unit, detach the handgrip and remove the object through the rear of the unit.
 - If obstruction cannot be cleared, take to an authorized Aerus location.
- After obstructions are cleared, plug power cord into outlet, turn cleaner **ON**, turn the *Sidekick*® **ON** and resume cleaning.

CAUTION: To prevent the *Sidekick*® motor from overheating, do not use if vacuum cleaner motor shuts **OFF**.

WARNING: Keep hands away from the *Sidekick*® brush while in use and when turning cleaner and the *Sidekick*® **ON** or **OFF**.

ACCESSORIES CADDY

The Accessories Caddy **T** is a compact and convenient way to organize and store your accessories. This lightweight tote will hold all of your Aerus above-the-floor tools including the amazing *Sidekick*®.

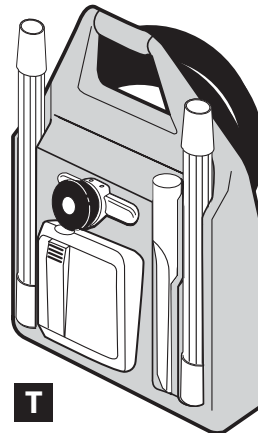

TO CHANGE FILTER BAGS

Protect your Warranty! Always use genuine Aerus™ high-efficiency, four-ply, self-sealing filter bags. Used exclusively, Aerus™ filter bags will promote longer motor life and more efficient cleaner operation.

NOTE: This cleaner is equipped with a device that prevents operation without a filter bag properly installed. Should you attempt to operate the cleaner without a filter bag the unit will not start. Be sure the filter bag is in place before operating the machine.

Changing bags is quick and easy:

- Press and hold either button **U** on the back of the bag compartment lid as you open the lid.
- As the cover opens, the filter bag seals itself for removal **U1**. Throw the old bag away - never attempt to reuse filter bags **U2**.
- Install a new filter bag and close lid.

Bag Change Indicator: Located on the top of the bag cover, the indicator **V** monitors air flow through the filter bag and cleaner. As the bag fills, air flow is reduced. As air flow is reduced, the indicator will gradually move until the window appears totally red **W**. When this occurs, stop vacuuming and replace your filter bag.

Remember that the indicator monitors air flow in the cleaner. When vacuuming fine particles such as powder and soot the bag may not seem "Full," however, the air flow has been greatly reduced and a bag change is required for peak cleaning performance.

Note: The Bag Change Indicator does not work while the accessory hose is attached.

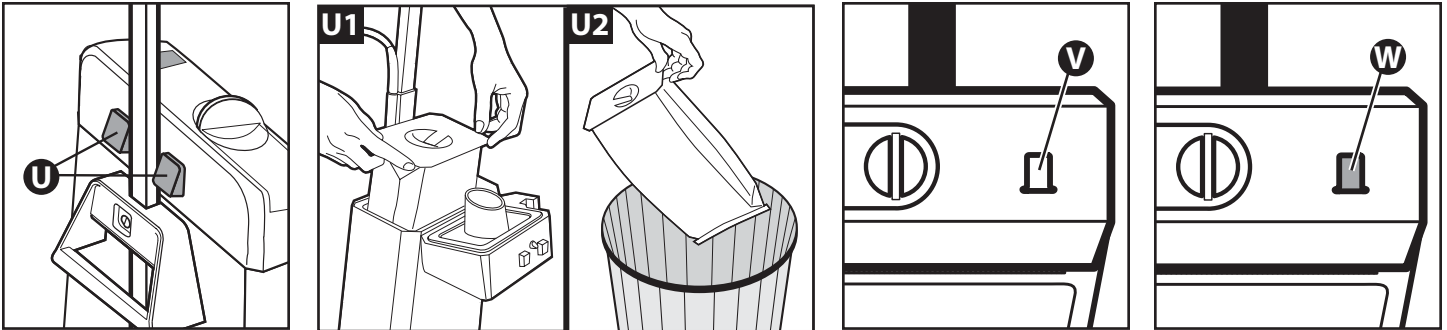

CLEANING THE AFTER BAG FILTER

This upright cleaner is supplied with an after bag filter that helps protect the motor from foreign objects that may accidentally be dropped into the bag compartment. This foam filter is in the bottom of the housing directly under the filter bag **X**. The after bag filter should be washed out after every sixth bag change. To do this, carefully lift the filter by the edges and wash in a warm mild detergent solution **Y**.

NOTE: Make certain the filter has dried completely before replacing it in the vacuum.

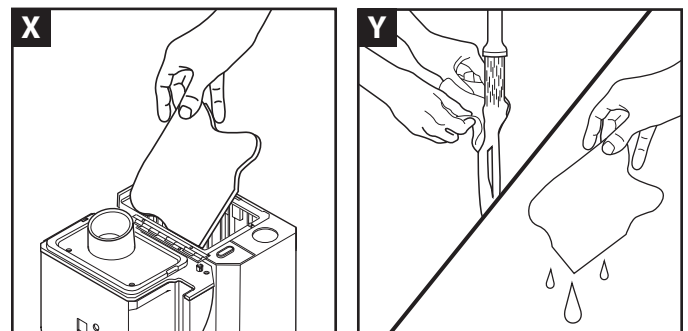

EXHAUST AFTERFILTER REPLACEMENT

Replace the exhaust afterfilter after every 3 filter bags.

Z To access the exhaust filter, depress latch button on front of afterfilter door and remove door by swinging it outward.

AA Remove used afterfilter from door ribs and discard.

BB Place new afterfilter on door. Afterfilter is trapezoidal in shape and will only fit over vents one way.

CC Insert posts on bottom of filter door into appropriate holes and close door.

DD Firmly press on the latch button to insure a positive lock of the door to the afterfilter housing.

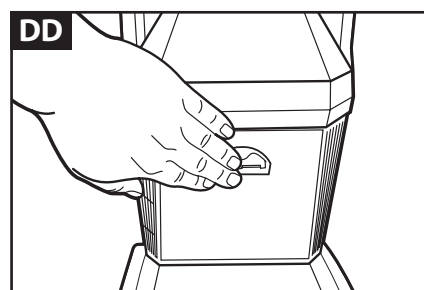
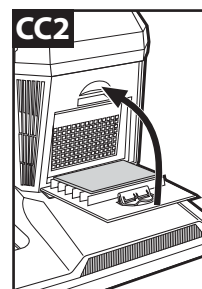
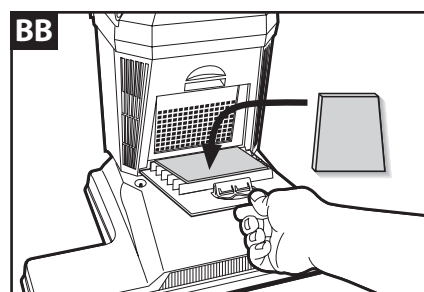
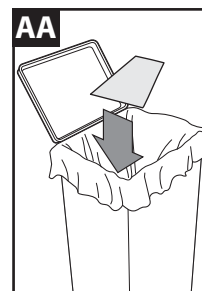
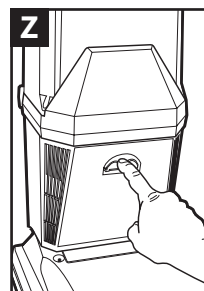
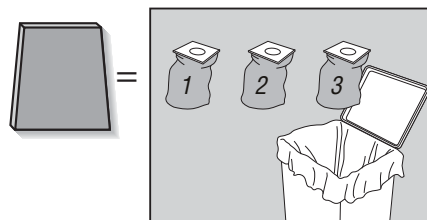

SERVICE

For prompt service, call the nearest Aerus location listed in your telephone directory. Your authorized Aerus location offers you the best in service both during and after the warranty period, as well as genuine Aerus™ parts and supplies.

If you have further questions, contact Aerus Customer Service at **1-800-243-9078 in the U.S.A.** and **1-800-668-0763 in Canada.** Or visit our website at **www.aerusonline.com**.

Every effort is made to ensure that customers receive an up-to-date instruction manual on the use of Aerus™ products; however, from time to time, modifications to our products may without notice make the information contained herein subject to alteration.

All power units of the Aerus™ Home Care System are certified by the Canadian Standards Association and listed by Underwriters Laboratories Incorporated.

FULL 10/5 YEAR WARRANTY

What is Covered by this Warranty - Aerus warrants its products to the consumer, subject to the conditions below, against defects in workmanship or material, provided that the products are returned to an authorized Aerus location within the following time periods: **Lux® Legacy™ upright vacuum cleaner, motors and fan unit** - within 10 years of date of purchase. **Attachments and accessories** - within 5 years of date of purchase.

How to Obtain Warranty Service - Upon contacting and returning, at consumer's sole cost and expense, the products with proof of purchase (including purchase date) to an Aerus location within the above time periods, Aerus will repair or replace and return the product without charge within a reasonable period of time, subject to the conditions in the above paragraph, if its examination shall disclose any part to be defective in workmanship or material. If Aerus, in its discretion, is unable to repair the product after a reasonable number of attempts, Aerus will provide either a refund of the purchase price or a replacement unit, at the company's option.

What is Not Covered by this Warranty - This product is intended for household use only. Ordinary wear and tear shall not be considered a defect in workmanship or material. These warranties do not apply for loss or damage caused by accident, fire, abuse, misuse, modification, misapplication, commercial use, or by any repairs other than those provided by an authorized Aerus™ Service Center. The warranty with respect to the motor and fan unit is null and void if it is damaged as a result of vacuuming damp or wet surfaces, or dirt leakage through a filter bag other than an Aerus™ filter bag.

Exclusion of Other Warranties and Conditions - EXCEPT AS PROVIDED HEREIN, AERUS MAKES NO REPRESENTATION OR WARRANTY OF ANY KIND. ALL OTHER WARRANTIES OF ANY KIND, EXPRESS OR IMPLIED, ARE HEREBY EXPRESSLY DISCLAIMED, INCLUDING ANY IMPLIED WARRANTY OF MERCHANTABILITY OR FITNESS FOR A PARTICULAR PURPOSE.

Limitation of Liability for Special, Incidental or Consequential Damages - AERUS SHALL NOT IN ANY CASE BE LIABLE FOR SPECIAL, INCIDENTAL OR CONSEQUENTIAL DAMAGES ARISING FROM BREACH OF EXPRESSED OR IMPLIED WARRANTIES, CONDITIONS, GUARANTEES OR REPRESENTATIONS, BREACH OF CONTRACT, NEGLIGENCE OR ANY OTHER LEGAL THEORY. Such excluded damages include, but are not limited to, loss of profits or revenue and loss of the use of the products.

For U.S. Application Only - This warranty gives you specific legal rights, and you may also have other rights which vary from state to state. Some states do not allow limitations on warranties, or on remedies for breach. In such states, the above limitations may not apply to you.

For Canadian Application Only - Exclusion of Subsequent Owners: Except as otherwise required by applicable legislation, this warranty is not transferable. This warranty gives you specific legal rights and you may also have other rights which vary from province to province. Some provinces and territories do not allow limitations on warranties, or on remedies for breach. In such provinces or territories, the above limitations may not apply to you.

If any provision of this warranty or part thereof is held by a court of competent jurisdiction to be invalid, illegal or unenforceable, the validity, legality and enforceability of the remaining provisions or parts thereof will not in any way be affected or impaired within the jurisdiction of that court. This entire warranty shall continue to be valid, legal and enforceable in any jurisdiction where a similar determination has not been made.

The Aerus Story

A fresh approach to a familiar idea.



CLEANER AIR THEN – ELECTROLUX

Since 1924, the name Electrolux has been synonymous with the best floor care in homes throughout North America. When it was introduced, its unique design became the standard of excellence almost overnight.

Electrolux, often referred to simply as Lux, also presented a higher measure of customer service. Loyal customers have become repeat customers not only because we have the best products, but also because we follow up with the best customer care. That is why Electrolux/Lux products have been proudly owned and serviced by over 50 million households and businesses.



And from the beginning, Electrolux customers have always been left with more than just clean floors. Their homes were left with cleaner air. Even 80 years ago, our products were

helping to eliminate household dust, mold spores, pollen and pet dander. When you think about it, we've been cleaning the air in people's homes for a very long time.

CLEANER AIR TOMORROW – AERUS

After being inside millions of homes and talking with millions of people, we learned quite a bit about how cleaner air creates a healthy living environment. This insight developed into an opportunity for us to evolve from Electrolux to our new company name Aerus. Based on the Greek word for "air," the name Aerus illustrates our mission to not only make homes cleaner, but to help make the lives of our customers better. Built on the foundation of our Electrolux heritage, Aerus is now positioned to help families live life well.

HEALTHIER LIVING FOREVER

Aerus doesn't just sell products and services to make homes cleaner. We are helping people take better care of their families. We are creating home environments that are safer, healthier and more inviting. Working with our personable and knowledgeable direct selling team, our customers will learn about new ways of living better. Our mission is to affect lives, not just homes.



Along with our innovative new products, we continue to offer our high-quality floor care products to deliver solutions that you want and need to protect your home. Aerus is focused on building upon that heritage of premium products featuring effective, cutting edge technologies in the indoor wellness space.

Welcome to the next generation of quality products. Aerus is committed to helping you live life well, building on over 8 decades of expertise, service, and trust under our Electrolux and Lux heritage.



For information regarding the use of this product please call our toll-free hotline:

1-800-243-9078 (in U.S.)
1-800-668-0763 (in Canada)

Pour toute question sur l'utilisation de cet appareil, appeler sans frais :
le **1 800 243-9078** (aux É.-U.)
ou le **1 800 668-0763** (au Canada)

Si desea información relacionada con el uso de este producto, llame a nuestra línea directa sin costo:

1-800-243-9078 (en EE.UU.)
1-800-668-0763 (en Canadá)

Aerus LLC 5956 Sherry Lane, Suite 1500, Dallas, Texas 75225
Aerus Canada, Inc. 3480 Laird Road, Suite 2-7, Mississauga (Ontario) L5L 5Y4
www.aerusonline.com



Aerus™ is a trademark owned by Aerus Concepts, L.P. Electrolux® and Lux® are registered trademarks of Aktiebolaget Electrolux and are licensed for use by Aerus LLC, Aerus Canada, Inc. and their affiliates.